

SYNRGY BLUESKY POST 98 INCH

SBS-P-98

Parts Manual

2/6/2024 1:12:53 AM

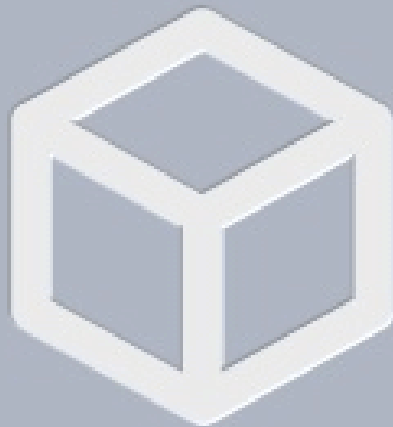

NO IMAGE AVAILABLE

Table of Contents

Post Assembly	3
Touch-Up Paints	4

Post Assembly

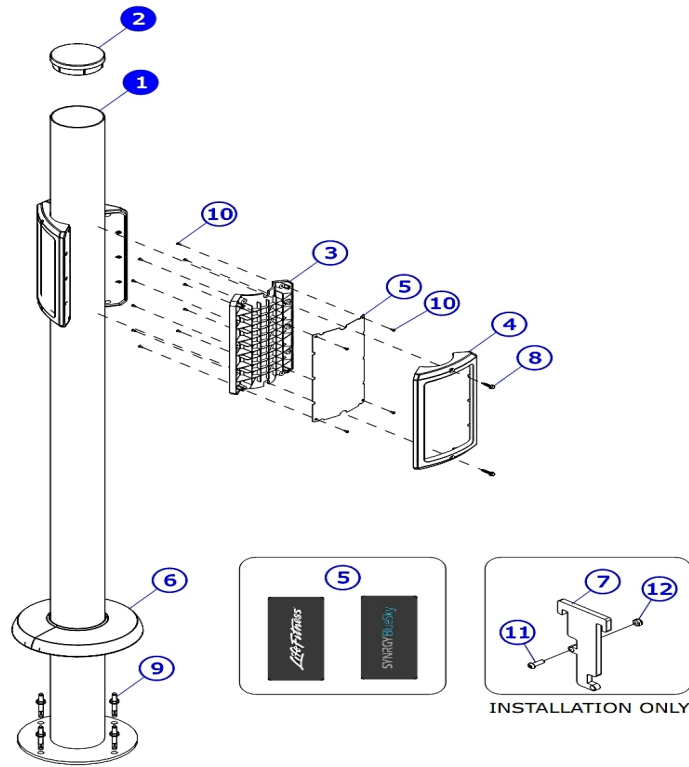

INSTALLATION ONLY

Ref #	Part Number	Qty	Description
1	999219P	1	LF POST 99" SMT WELDMENT PAINTED
2	999070P	1	LF 5" POST CAP PAINTED
3	9511301	3	MOUNT, PLACARD, 5 INCH TUBE
4	9511401	3	BEZEL, PLACARD, 5 INCH TUBE #999072
5	999359	1	SYNRGY BLUESKY
5	999207	1	LIFE FITNESS SIGN
6	911350	1	LF LARGE ESCUTCHEON PARTS CARTON
7	999319	1	HANGER TOOL FOR OVERHEAD F/LF
8	104403	6	BOLT 1/4-14 X 1 1/4 HEX WASHER TEK
9	200001776	4	ANCHOR CONCRETE WEDGE M10 X 1.50 X 100MM
10	999215	36	SCREW,8-20 PHL PAN PLT ST
11	200002150	2	SCREW MACH BUTTONHEAD M10 X 1.5 X 55 MM
12	200001938	2	NUT HEX M10 X 1.50 S.S.
-	200001175	1	T-45 TAMPER PROOF DRIVER BIT (T45)

Touch-Up Paints



Ref #	Part Number	Qty	Description
-	115209YW	1	PAINT, TOUCH-UP BRUSH, YELLOW
-	115208DB	1	PAINT, TOUCH-UP AEROSOL, BLUE
-	115208BU	1	PAINT, TOUCH-UP AEROSOL, BURGUNDY
-	115208GD	1	PAINT, TOUCH-UP AEROSOL, DARK GRAY
-	200305466	1	PAINT, TOUCH-UP AEROSOL, SLATE GRAY
-	115209DB	1	PAINT, TOUCH-UP BRUSH, BLUE
-	115208FG	1	PAINT, TOUCH-UP AEROSOL, FOREST GREEN
-	115209FG	1	PAINT, TOUCH-UP BRUSH, FOREST GREEN
-	115208CT	1	PAINT, TOUCH-UP AEROSOL, CHARTREUSE
-	115208SA	1	PAINT, TOUCH-UP AEROSOL, SAFARI
-	115209BK	1	PAINT, TOUCH-UP BRUSH, BLACK
-	200305467	1	PAINT, TOUCH-UP BRUSH, SLATE GRAY
-	115209SA	1	PAINT, TOUCH-UP BRUSH, SAFARI
-	115208BK	1	PAINT, TOUCH-UP AEROSOL, BLACK
-	115209CT	1	PAINT, TOUCH-UP BRUSH, CHARTREUSE
-	115209BU	1	PAINT, TOUCH-UP BRUSH, BURGUNDY
-	115208YW	1	PAINT, TOUCH-UP AEROSOL, YELLOW
-	115208OR	1	PAINT, TOUCH-UP AEROSOL, ORANGE
-	115208MA	1	PAINT, TOUCH-UP AEROSOL, MAHOGANY
-	115208DGY	1	PAINT, TOUCH-UP AEROSOL, LIGHT GRAY
-	115209OR	1	PAINT, TOUCH-UP BRUSH, ORANGE
-	115209DGY	1	PAINT, TOUCH-UP BRUSH, LIGHT GRAY

Ref #	Part Number	Qty	Description
-	115209MA	1	PAINT, TOUCH-UP BRUSH, MAHOGANY
-	115209GD	1	PAINT, TOUCH-UP BRUSH, DARK GRAY

